

**Bar Maid® Corporation**  
2950 NW 22nd Terrace  
Pompano Beach, FL 33069  
TEL (954) 960-1468 • FAX (954) 960-1647  
www.barmaidwashers.com



**Bar Maid®**



**FOR PARTS OR SERVICE  
INFORMATION**  
please contact us at the numbers listed  
or call the Bar Maid Customer Service  
line at: 1-800-526-5278

# CARE AND MAINTENANCE / OPERATING INSTRUCTIONS

Congratulations on your purchase of the finest Glass Washer made. Bar Maid® machines are manufactured and tested to meet the toughest safety and sanitation standards. Please follow these instructions carefully. Failing to do so in some cases may damage the machine, cause injury to the operator and/or void warranty.

## IMPORTANT!! PLEASE READ THIS FIRST:

- 1 Plug unit **only** into a **GROUND**ED outlet that matches the voltage/cycle as listed on the motor. Outlet must be equipped with a ground-fault circuit interrupter (G.F.C.I.).
- 2 Keep electrical cord clear of brushes and water.
- 3 Switches and blue switch boxes (for SS Model) must **NOT** contact water. **ATTACH BOX TO A DRY LOCATION with screws provided.**
- 4 **DO NOT** operate machine out of water. **DO NOT** use any machine if the power cord or motor housing is cracked or damaged.
- 5 Ensure brushes are securely in place before turning machine on.
- 6 Use machine only for the purpose it was intended.
- 7 Disconnect from the power source before servicing.
- 8 Do not use if any parts are cracked, broken or leaking oil.
- 9 Do not remove the safety clamp from SS motor.
- 10 **CAUTION: Use only genuine Bar Maid® replacement parts.**
- 11 **Keep machines upright!! Lying on side may cause damage.**

## CARE AND MAINTENANCE

A few simple procedures will help ensure a long, trouble-free life:

- 1 When closing for the day, drain sink and wipe off machine.
- 2 **LET WASHER DRY** overnight.
- 3 Once per month, carefully lift off rubber band that protects gear housing. Immerse machine in enough water to cover brushes and add a half cup of vinegar or bleach. Run machine for ten minutes, rinse thoroughly and replace band. Check overall condition. If any parts appear cracked or damaged, please write, call or fax for service information and replacement parts.

## OPERATING INSTRUCTIONS - ALL MODELS

- 1 Place unit in sink and fill with warm water to 1/2 inch below the top of the brushes on the A-200/205 model or the water line label on other models. Water must be comfortable to touch, 115°F maximum. Add a quality liquid "low suds" detergent such as Bar Maid® LoSUDS®. Granular (powder) detergents are not recommended as they can be abrasive and cause premature wear to gears and bearings.
  - 2 Plug machine into a grounded, G.F.C.I. (ground-fault circuit interrupter) equipped outlet. If the machine is equipped with a G.F.C.I., test and reset. Turn machine on.
- IMPORTANT NOTE:** SS Model Submersible machines are equipped with a 125° thermal cut-off to protect from over-heating. Excessively hot water may cause the machine to shut off. If this occurs, drain sink and refill with only warm water. Wait 20 minutes for machine to cool down and then restart. If machine fails to start, test and reset G.F.C.I. unit on cord (if so equipped) or receptacle.
- 3 For best results, wash one glass at a time. **Always** start the Glass Washer before placing glass over the brush. The center brush scrubs the inside of the glass while the four outside brushes wash the outside. If taller glasses are washed, a longer center brush can be used. (see Accessories). Rinse in fresh water in second sink, then in third sink sanitize the glass. Let drain.

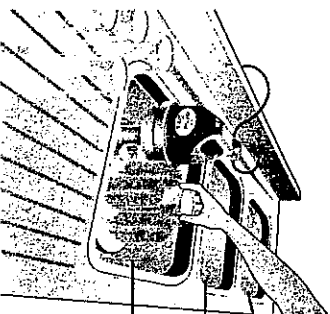

Fresh water & sanitizer

Fresh water rinse

Glass Washer with Detergent

# SS-100-D



Model

SS-100-D

Submersible Glass Washer

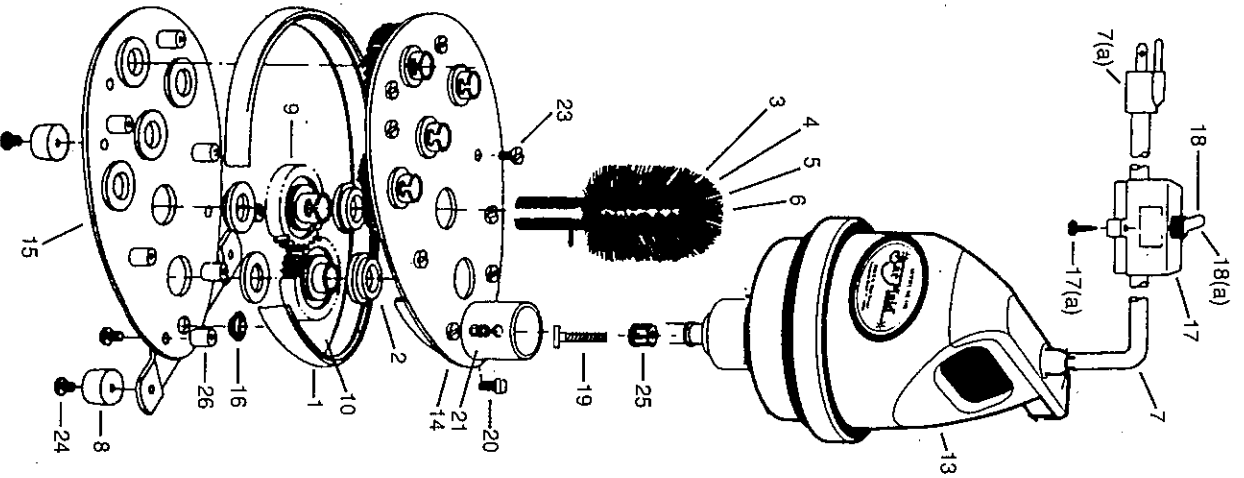
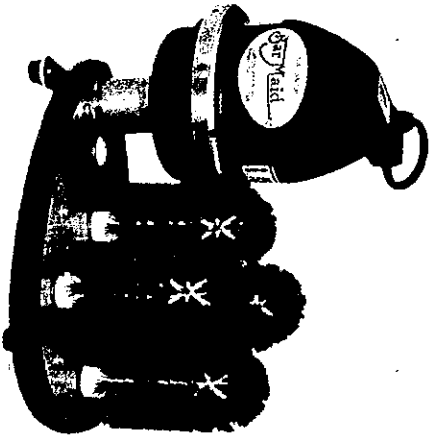

Powerful 1/3 HP motor, heavy-duty stainless construction and bronze bearings deliver outstanding performance and reliability. Bar Maid's stainless motor clamp and G.F.C.I. included. ETL approved to UL, CSA & NSF.

Part Number	Product Description	Diagram #	Qty Required
BAN 865	BAND • gear protector	1	1
BER 860	BEARINGS • bronze gear bearings (sets available - see back page)	2	12
BRS-980	BRUSHES • 4 inch scrub brush / muffin pan brush	3	4
BRS-917	BRUSHES • 6 inch standard	4	5
BRS-920	BRUSHES • 6 3/4 inch for slightly taller glassware	5	5
BRS-922	BRUSH • 7 1/2 inch tall brush	6	5
BRS-975	BRUSH • 8 1/2 inch extra tall brush	6	1
COR-115 or COR-120	CORD • with switch assembly & GFCI for Model SS • with switch assembly (no GFCI) for Model SS	7	1
GFI-100	G.F.C.I. • ground fault interrupter safety device	7(a)	1
FET-850S	FEET SET • 4 black rubber feet with 4 screws	8	1 set
GER-905	GEARS • drive gears (to drive the brushes) (sets available - see back page)	9	5
GER-906	GEAR • idler gear	10	1
MTR-801	MOTOR • Model SS (110V) with switch and G.F.C.I.	13	1
MTR-830	MOTOR • Model SS (220V - 50Hz) with switch	13	1
PLT-101	PLATE • top plate for Model SS	14	1
PLT-102	PLATE • bottom plate for Model SS	15	1
PPP-185	PLASTIC PLUG • for bottom plate for Model SS	16	1
SWA-150	SWITCH ASSEMBLY • Includes an "O" ring, switch, switch boot, switch box, 4 bottom and 2 side screws, and 2 terminals for Model SS.	17	1
SBX-110	SWITCH BOX • without switch for Model SS	17	1
SCR-160	SCREWS • for switch box bottom on Model SS	not shown	4
SCR-165	SCREWS • for switch box sides on Model SS	17(a)	2
SBC-230	SWITCH COVER • switch cover w/nut	18	1
SWT-196	SWITCH • heavy duty 20 amp toggle switch	18(a)	1
SCR-145	SCREW • for drive shaft pinion on Model SS	19	1
SCR-150	SCREW • back plate - square head for Model SS	20	1
SCR-155	SCREWS • socket set - Model SS motor mounting screw	21	3
SCR-875	SCREWS • plate screw	23	13
SCR-876/877	THROUGH BOLT/ NUT ASSEMBLY • for Model A and SS	23	SS=6 A=9
SHF-135	SHAFT • drive shaft pinion gear for Model SS	25	1
SPA-896	SPACER • plate spacer	26	7

Order Line 1-800-526-5278 / Order Fax 1-800-457-5612